

**CUSTOMER COPY**

REV.	DESCRIPTION	APP.	DATE
A	NEW DESIGN	Amos	2012-11-15

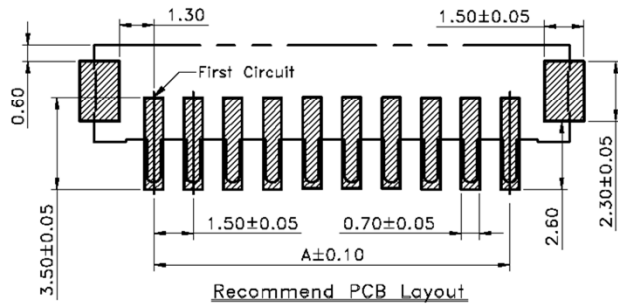

Recommend PCB Layout

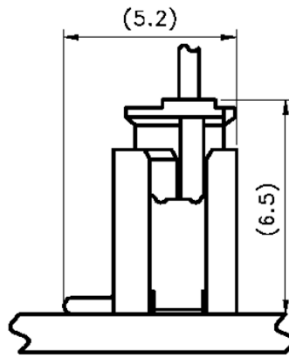

Assembly Layout (REF.)

**ORDER INFORMATION**

1206 5 X 0 XX X

1:Plating Tin  
3:Plating Gold Flash

No. of Contact

2:180° SMT  
4:180° SMT+Cap

ZH Type

Poles	Dimensions (mm)		
	A	B	C
2	1.50	6.00	3.60
3	3.00	7.50	5.10
4	4.50	9.00	6.60
5	6.00	10.50	8.10
6	7.50	12.00	9.60
7	9.00	13.50	11.10
8	10.50	15.00	12.60
9	12.00	16.50	14.10
10	13.50	18.00	15.60
11	15.00	19.50	17.10
12	16.50	21.00	18.60
13	18.00	22.50	20.10
14	19.50	24.00	21.60
15	21.00	25.50	23.10

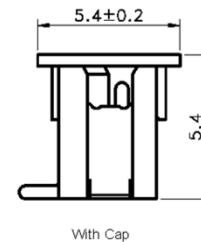
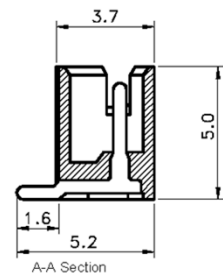
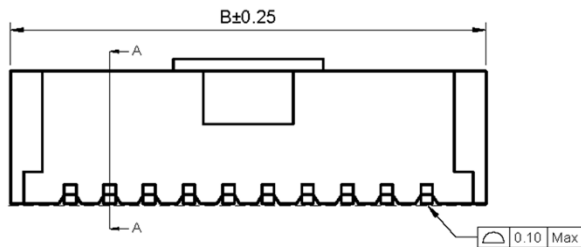
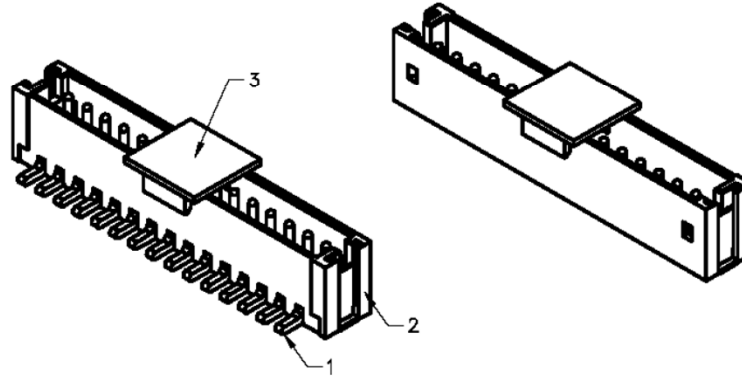
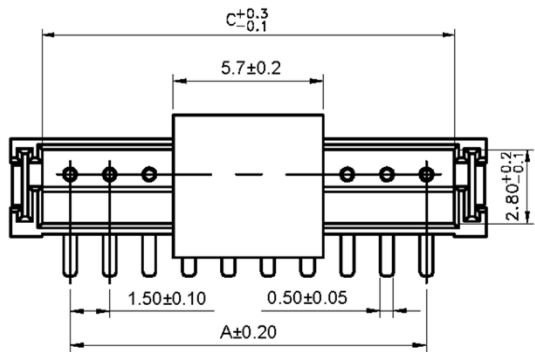

With Cap

**SPECIFICATIONS**

- Voltage Rating : 50V AC/DC
- Current Rating : 1A AC/DC
- Withstanding Voltage : 500V AC/minute
- Insulation Resistance : 500MΩ min
- Temperature Range : - 25°C to + 85°C
- Contact Resistance : 20mΩ max

**Material :**

- 1.Contact : Brass, Plated: Refer Above Options
- 2.Base: Nylon 9T UL94V-0
- 3.Cap:Nylon PA46 UL94V-0



鈺滿榮企業股份有限公司 ACMELUX CO., LTD.

TEL:886-2-85124595

FAX:886-2-85124322

0.0±0.30	SCALE: 1:1	TITLE:	PART NO:
0.00±0.20	UNT: mm	Pitch 1.5mm 180° SMT ZH Type	APP BY: <i>Hung</i>
0.000±0.1		Wafer Connector	CHK BY: <i>Cheryl</i>

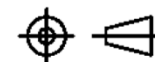

MATL: RoHS

DWG. NO. C12065X0XXX

DR BY: *Amos*

A244